

## UHWII1.5

### 16:9 LED Display Unit



#### Main Specifications:

1. Golden 16:9 ratio. splicing FHD/UHD dot to dot.
2. Full front maintenance of all components.
3. High protection and precision, IP60 for rear.

#### Main Technical Specifications:

Parameter	Value
Pixel Pitch	1.58mm
LED Type	3-in-1 SMD
LED Configuration	1Red,1Green,1Blue
Brightness	600cd/m <sup>2</sup>
Pixels Per Panel	384x216 Dots
Pixel Density	396,550 pixels/m <sup>2</sup>
Weight	7 kg/panel
Module Size	W152.48mmxH171.54mm
Cabinet Size	W609.92mmxH343.08mmxD68mm
Cabinet Diagonal	27.5" (699.79mm)
Aspect Ratio	16:9
Area	0.209 m <sup>2</sup>

<b>Planeness</b>	≤0.15mm
<b>Recommended Viewing Distance</b>	≥1.5 m
<b>Material</b>	Die-casting Aluminum
<b>Environment</b>	Indoor
<b>Ingress Protection</b>	IP60
<b>Operating Temperature/Humidity</b>	-10°C~+45°C/10~80%RH
<b>Storage Temperature/Humidity</b>	-20°C~+55°C/10~85%RH
<b>Maintenance</b>	Front service of module, system card ,power supply
<b>Curve</b>	Inner 0° ~+7°
<b>Gap Between Modules</b>	Seamless
<b>Horizontal Viewing Angle</b>	160°
<b>Vertical Viewing Angle</b>	160°
<b>Color Temperature</b>	2000-9500K Adjustable
<b>Colors</b>	4.4 Trillion
<b>Brightness Control</b>	Manual/Automatic
<b>Input Power &lt;Max&gt;</b>	140W/panel
<b>Input Power &lt;Typical&gt;</b>	46W/panel
<b>Driving Method</b>	Constant Current Drive
<b>Video Frame Rate</b>	50/60 Hz
<b>Rate Refresh</b>	1920 Hz
<b>Input Voltage</b>	100~240VAC
<b>Input Power Frequency</b>	50~60 Hz
<b>Input Signal</b>	DVI/HDMI/VGA/SDI/DP/AV/S-Video, etc
<b>Calibration</b>	Support brightness and chroma
<b>Acoustic Noise</b>	Fanless operation
<b>LED Life Time</b>	≥50,000 Hours
<b>LED Wavelength</b>	R:620~630nm G:520~535nm B:465~475nm
<b>Standard Mounting Configuration</b>	Fixed
<b>Optional Mounting Configuration</b>	Wall-mounting , Concave ( recommend rear installation )
<b>Professional Services</b>	Design, configuration, install and service available
<b>Power Status</b>	Diagnostic LEDs
<b>Video Signal Redundancy</b>	Optional
<b>Video Extension Redundancy</b>	Optional
<b>Data Interconnection</b>	Network Cable ( L≤100m ); multi-mode fiber ( L≤300m ); single mode fiber ( L≤15km )

**Note: Specifications are for reference only and are subject to change without notice.**

# Cabinet Drawing:

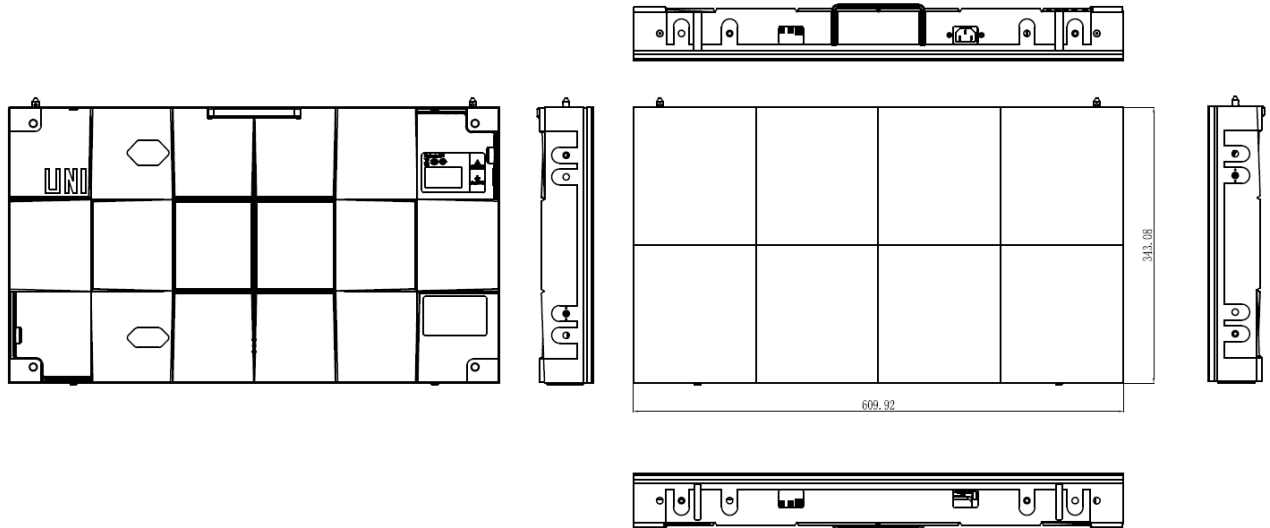

Unilumin